

Partition FIBRAN TECNO 175/75

Partition drywall EI240/120 - thickness 175 mm

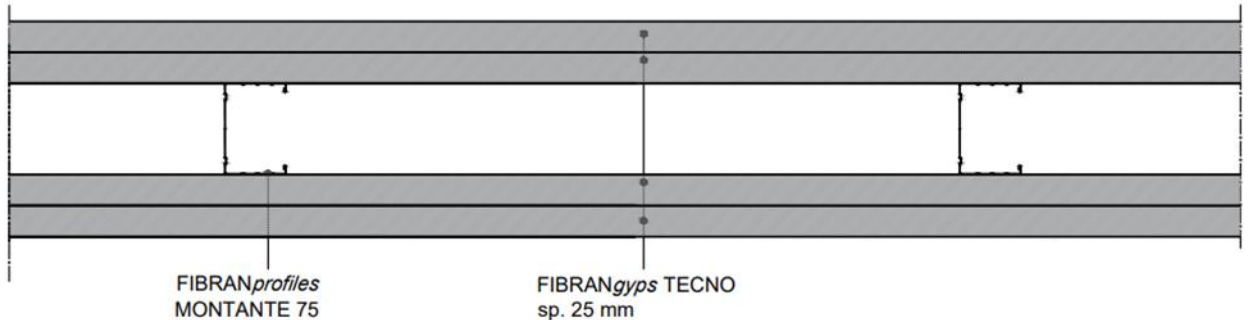

COMPONENTS

Panel

Double layer of **FIBRANGyps TECNO** each side, a prefabricated panel composed of fiber-reinforced gypsum, characterized by a male-female joint on the perimeter edges, CE marked according to ETA 22/0087. FIBRANGyps TECNO is incombustible **Euroclass A1**. It is recommended to use **FIBRANGyps TECNO H (Hydro)** as a first row.

It must be installed with the special gypsum based glue/finishing FIBRANGyps FT3 or/and FT3H, FIBRANGyps SCREW.

Metal frame thickness 0,6 mm conform to EN 14195

Channels **FIBRANprofiles GUIDA 75** mechanically fixed to the floor and ceiling using fixing nails at a maximum spacing of 500 mm;

Studs **FIBRANprofiles MONTANTE 75**, max axial spacing every 600 mm, slotted to allow passage of the installations.

If the wall is mounted on a rough floor, use the **FIBRANprofiles FT 1718 starting profile**, 0.7 mm thick, with Z140 zinc plating, mechanically fixed to the metal uprights using FIBRANGyps TEKS screws.

Screws

Fixing the panels with phosphated self-tapping **FIBRANGyps SCREW 3.5x45 and 4,8x70mm** with resistance to salt spray not less than 72 hours, placed at a maximum center distance of 300 mm.

Fix the starting profile **FT 1718** (when necessary) and the uprights to the floor guide with screws FIBRANGyps **TEKS 4.2x13** mm.

Tapes and glue / smoothing compound

Double-sided closed cell polyethylene foam tape FIBRANGyps 3.5 mm thickness to be applied on the entire perimeter of the metal structure, in order to eliminate any acoustic bridges.

Mono-adhesive closed cell polyethylene foam tape **FIBRANGyps FT mono**, 2 mm thick and 40 mm wide, to be applied on the wings of the uprights before laying the panels.

Bonding of FIBRANGyps TECNO panel joints using **FIBRANGyps FT3 or FT3H** glue - smoothing compound.

Finishing of the joints, the screw heads and the surface of the panels with the glue - smoothing compound **FIBRANGyps FT3 or FT3H**.

Partition FIBRAN **TECNO 175/75**

Technical features

Fire rating

EI 240 Classification Report IG 385404/4154FR according to EN 1364-1 valid until Hmax 5,2 m
 EI 240 from 5,2m to 6 m with a third layer each side.
EI 120 from 6 to 12 m according to EXAP

Mechanical performance

FIBRANprofiles channels and studs DIN 75 mm, max axial spacing every 600 mm, thickness 6/10 mm conform to EN 14195.

Profiles must be designed according to local regulation and specific application.

In case of walls longer than 15 meters, an expansion joint must be made every 10 meters or at structural joints.

The system, with metal structure 75 uprights, was tested at the ITC-CNR laboratory and obtained the **ETA** certification n ° **22-0087** with:

- 1) resistance to dynamic loads
 - structural damage _ category of use III
 - functional damage _ category of use IV
- 2) resistance to eccentric vertical loads:
 - functional damage _ load category A.

Sustainability

FIBRANgyps **TECNO** and **TECNO H** are classified A+, the best one according to EN ISO 16000-09, with regards to the emission of formaldehyde, acetaldehyde and other substances

FIBRAN S.p.A. reserves the right to modify or change the technical data, instructions and advice contained in this document without notice. It is the Customer's responsibility to verify that the technical information is suitable for the specific intended use. For more technical information, visit the website www.fibran.it or the Technical Office.

21/07/2023